

MESUCO 132X rapido

Con INDAmatic integrato

- > INDAmatic sul collo della cerniera per una chiusura silenziosa.
- > Il sistema di ammortizzazione è completamente invisibile.
- > Programma: cerniera standard a 110°, collo dritto, mezzo collo e collo alto.
- > La MESUCO 132X è concepita per porte da 14 a 26 mm di spessore.
- > Chiusura uniforme e ammortizzata garantita, senza necessità di montaggi extra.



INDAmatic

1 GAMMA DI CERNIERE

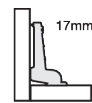
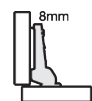
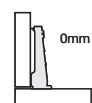

988.715.066*
* Fornito su richiesta

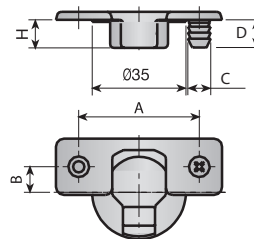

NICHEL				
A:48, B:6			A:45, B:9.5	
Montaggio a vite	Montaggio a pressione D:10	Montaggio ad espansione D:10	Montaggio a vite	Montaggio ad espan D:10

<p>$\alpha = 0^\circ \div 110^\circ$ H = 11.3</p>	0mm.	320.010.062	320.020.061	320.030.060	320.110.066	320.130.064
	8mm.	320.011.064	320.021.063	320.031.062	320.111.061	
	17mm.	320.012.066	320.022.065	320.032.064	320.112.063	
<p>$\alpha = 0^\circ \div 165^\circ$ H = 11.3</p>	0mm.	320.040.066			320.140.063	
<p>$\alpha = 90^\circ \div 200^\circ$ H = 11.3</p>	0mm.	320.090.061				
<p>$\alpha = 45^\circ \div 155^\circ$ H = 11.3</p>	0mm.				320.180.066	



988.715.066*

* Fornito su richiesta

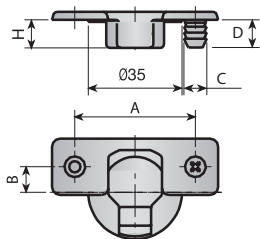









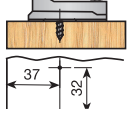

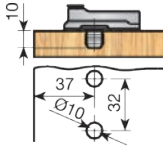

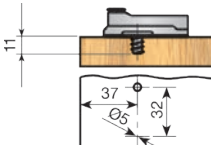

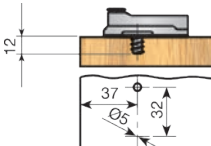
NICHEL

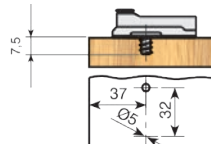
A:52, B:5.5

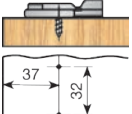
NICHEL			
A:52, B:5.5			
Montaggio a vite	Montaggio a pressione D:10	Montaggio ad espansione D:10	Euro-vite premontata
320.210.063	320.220.062	320.230.061	320.330.065
320.211.065	320.221.064	320.231.063	320.331.060
320.212.060	320.222.066	320.232.065	320.332.062

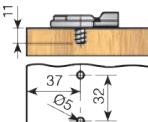
2 BASETTE

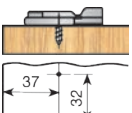
ALTEZZE in mm.			0	2	4	
		Montaggio a vite Regolazione verticale ± 2 mm	Acciaio Nichel	350.210.066	350.212.063	350.214.060
		Montaggio a pressione Regolazione verticale ± 2 mm	Acciaio Nichel	350.220.065	350.222.062	350.224.066
		Euro-vite premontata Regolazione verticale ± 2 mm	Acciaio Nichel	350.230.061	350.232.061	350.234.065
		Basetta con centratore Regolazione verticale ± 2 mm	Acciaio Nichel	348.500.062	348.502.066	348.504.063
		Basetta con centratore corto Regolazione verticale ± 2 mm	Acciaio Nichel	390.010.062	390.012.066	
		Montaggio a vite Regolazione verticale $\pm 1,6$ mm eccentrico	Acciaio Nichel	348.600.066	348.602.063	
		Euro-vite premontata Regolazione verticale $\pm 1,6$ mm eccentrico	Acciaio Nichel	348.400.065		
		Montaggio a vite Regolazione verticale ± 2 mm	Acciaio Nichel	350.215.063		

3 DATI TECNICI

MESUCO 132X RAPIDO Apertura 110°

Collo dritto



Calcolo altezza della basetta
 $C = B + K - D$
 K = Costante = 10,5mm

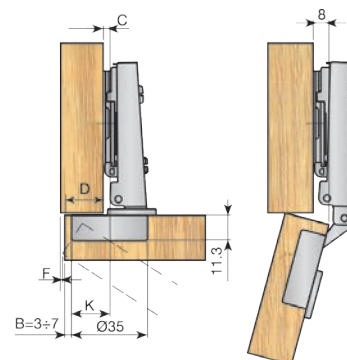

Mezzo collo



Calcolo altezza della basetta
 $C = B + K - D$
 K = Costante = 2,5mm

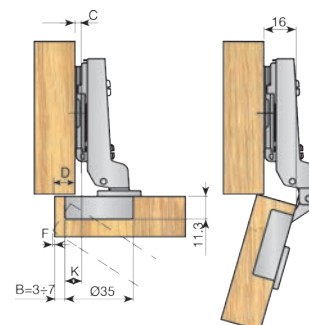

Collo alto*



Calcolo altezza della basetta
 $C = B + K + D$
 K = Costante = -6,5mm

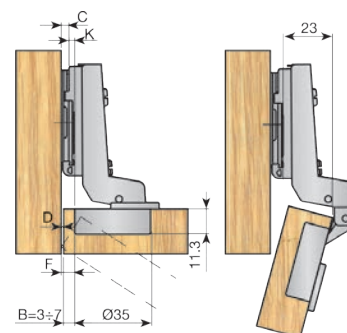

* Per essere fissata, la basetta deve essere spostata indietro ad una distanza pari allo spessore della porta + 1mm

Posizionamento laterale della porta (F).

mm	Spessore della porta								
B	16	17	18	19	20	21	22	23	24
3	0,8	1	1,4	1,8	2,2	2,8	3,5	4,3	5,0
4	0,8	1	1,4	1,7	2,1	2,7	3,3	4,3	4,7
5	0,8	1	1,4	1,6	2,0	2,5	3,1	3,7	4,4
6	0,8	1	1,4	1,6	2,0	2,4	2,9	3,5	4,1
7	0,7	0,9	1,2	1,5	1,9	2,3	2,8	3,3	3,8

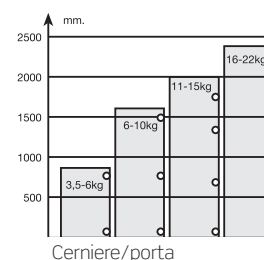
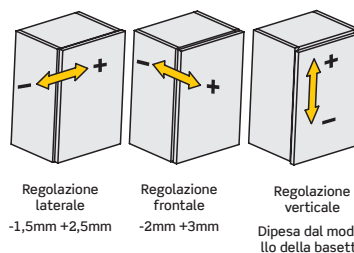

4 COVERS

Cover per cerniere.

Collo dritto	Nichelato	302.431.065
Mezzo collo / Collo alto	Nichelato	302.531.062

La cover può essere personalizzata mediante stampa o serigrafia.

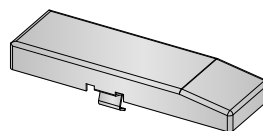

Collo dritto

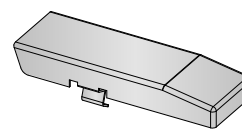

Mezzo collo / Collo alto

Riduttore angolo di apertura per cerniera 110°

Bianco	352.600.006
--------	-------------



